

# FLAT SEAL

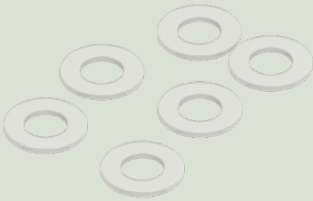

Laboratorier og analyse, Industrial Process



# Products

Product Number	Short Designation
151862	FLAT SEAL PA 6.6 GAUGE G1/4
151606	SEALS - ANNEALED CU G1/4 (X10)
151607	SEALS - ANNEALED CU M10*100
17204	PAKNING 11X 5X1,5 PTFCE 1/4-MANO (10ST)
82075	SEAL 18X12X1,5MM COPPER
124737	FLAT SEAL FOR GAUGE G1/4 5,2X 9,6X 3 ALU
167800	KIT OF SEALS FLAT PA 6.6 MANO M10x1
17203	PAKNING 18X12X2 MM PTFCE
17133	PAKNING 11,5X7,2X3MM KON TEFLON®
17206	PAKNINGSSÆT 11X 5X1&0,5 AL (G1/4")-10ST
17207	PACKNING 18X7X2MM PTFCE (TYPE J&K)
29053	PAKNING 20X12X2 NYLON (TYP B)
29186	FLAT SEAL PA 6-6 14x9x2
29187	PACKNING 18X11,8X2 MM NYLON
29226	10 GASKETS 16X9,2X2 PTFCE
175548	KIT 2 SEALS 18x12x1,5 MM ANNEALED COPPER
17141	PAKNING 14,5X10X2 MM PTFCE G3/8-GEV